

# ROCKY CREEK TOPOGRAPHIC WORK MAP

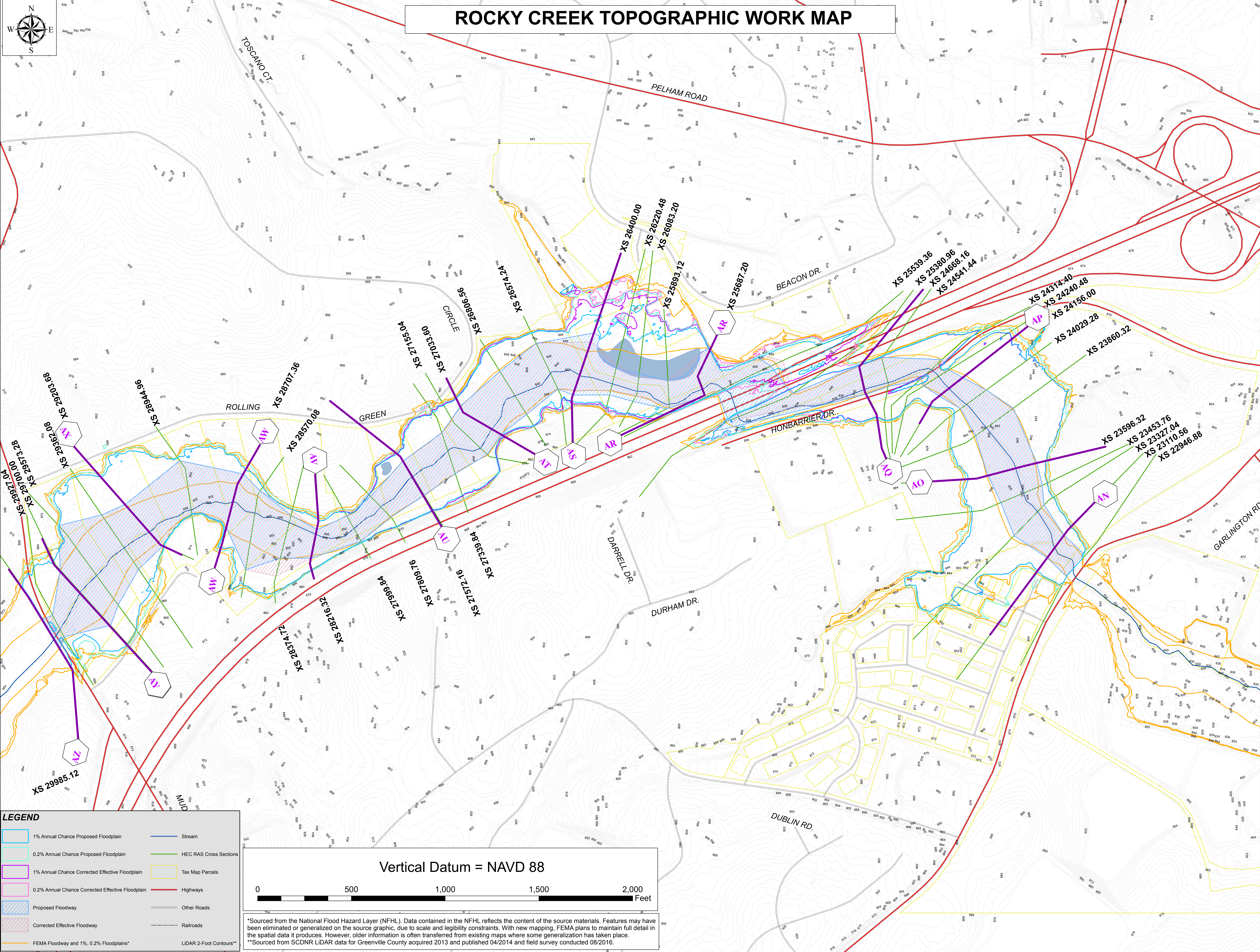

**LEGEND**

1% Annual Chance Proposed Floodplain	Stream
0.2% Annual Chance Proposed Floodplain	HEC RAS Cross Sections
1% Annual Chance Corrected Effective Floodplain	Tax Map Parcels
0.2% Annual Chance Corrected Effective Floodplain	Highways
Proposed Floodway	Other Roads
Corrected Effective Floodway	Railroads
FEMA Floodway and 1%, 0.2% Floodplains*	LiDAR 2-Foot Contours**

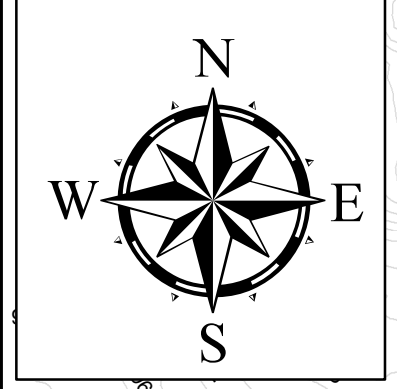
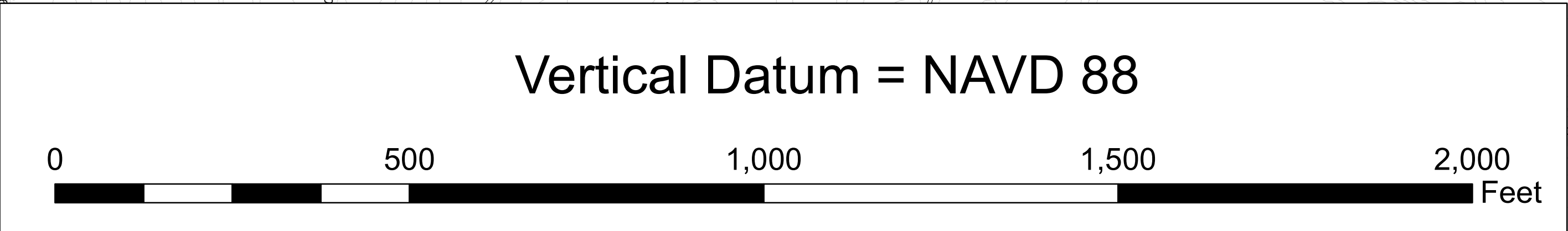

\*Sourced from the National Flood Hazard Layer (NFHL). Data contained in the NFHL reflects the content of the source materials. Features may have been eliminated or generalized on the source graphic, due to scale and legibility constraints. With new mapping, FEMA plans to maintain full detail in the spatial data it produces. However, older information is often transferred from existing maps where some generalization has taken place.  
 \*\*Sourced from SCDNR LiDAR data for Greenville County acquired 2013 and published 04/2014 and field survey conducted 08/2016.